

# IR REAR VIEW SYSTEM HTC-70 SERIES

## Main Features

- Weatherproof: IP68
- IR distance: 12 Meter
- 0 Lux IR ON
- Easy installation
- Rear View System (optional)



## Interface

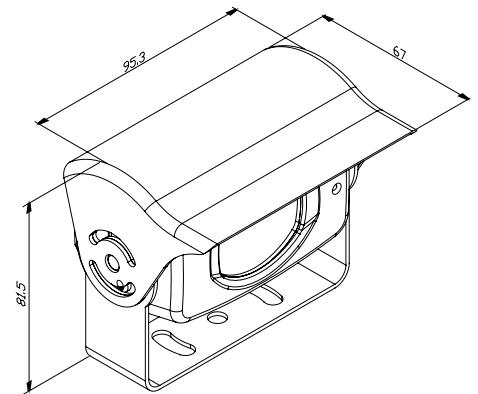

## Specifications

ITEMS	HTC-70B	
PICK UP DEVICE	1/3" or 1/4" CCD Image Sensor	
SYSTEM	NTSC	PAL
PICTURE ELEMENTS H*V	510 * 492	500 * 582
H. SYNC. FREQUENCY	15.734KHz	15.625KHz
V. SYNC. FREQUENCY	59.94Hz	50Hz
HORIZONTAL RESOLUTION	420 TV Lines	
SCANNING SYSTEM	2:1 Interlace	
SENSITIVITY	0 Lux When IR On	
SYNCHRONIZATION	Internal	
S/N RATIO	More Than 48 dB (AGC Off)	
BACK LIGHT COMPENSATION	Auto	
ELECTRONIC SHUTTER	Auto ,Range 1/50(1/60) Up to 1/100,000 sec.	
GAIN CONTROL	Auto	
GAMMA	0.45	
LENS	3.6mm / F2.0	
LED	12 Units 850nm Infrared LED, 10,000hrs	
VIDEO OUTPUT	1 Vpp, 75 Ohms	
WEATHER PROOF IP RATING	IP68	
POWER SUPPLY	DC 12V	
POWER CONSUMPTION	170 mA	

ITEMS	HTC-70B
DIMENSIONS (W*H*D)	95.3 * 81.5 * 67mm
WEIGHT	480g
STORAGE TEMPERATURE	-30 to + 60 °C
OPERATING TEMPERATURE	-10 to + 45°C

SPECIFICATIONS ARE SUBJECT TO CHANGE WITHOUT NOTICE

