

## HTC-15 SERIES

### Main Features

- IR Distance: 20M (optional)
- High Res up to 540 TVL
- Mechanical ICR
- Day/Night Function
- Non IR Model also available
- Line Lock Available



### Interface

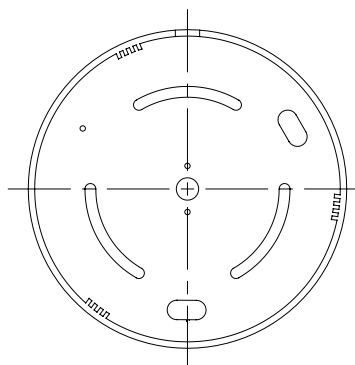
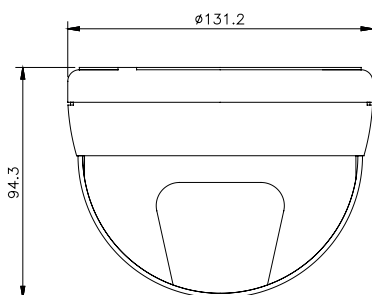

### Specifications

ITEM	HTC-15B		HTC-15I	
	NTSC	PAL	NTSC	PAL
PICK UP DEVICE	1/3" CCD Image Sensor			
SYSTEM	NTSC	PAL	NTSC	PAL
PICTURE ELEMENTS H*V	510 * 492	500 * 582	768 * 494	752 * 582
H. SYNC. FREQUENCY	15.734 KHz	15.625 KHz	15.734 KHz	15.625 KHz
V. SYNC. FREQUENCY	59.94Hz	50Hz	59.94Hz	50Hz
HORIZONTAL RESOLUTION	420 TV Lines		540 TV Lines	
SCANNING SYSTEM	2:1 Interlace			
SENSITIVITY	0 Lux When IR On			
SYNCHRONIZATION	Internal/DC Type; Line Lock /AC Type Only			
S/N RATIO	More Than 48 dB (AGC Off)			
BACK LIGHT COMPENSATION	Board Lens Auto; Auto IRIS ON/OFF Switchable Range			
ELECTRONIC SHUTTER	Switchable Range 1/50(1/60) Up to 1/100,000 sec.			
GAIN CONTROL	Auto			
GAMMA	0.45			
IR CUT FILTER CHANGE	IR Cut Removable Lens (IR Model Only)			
LENS	Board Lens: 3.6 mm (3, 6, 8, 12 mm Optional) Varifocal Auto Iris Lens: 4~9 mm or 3.7~12 mm			
LED	24 Units 850 nm Infrared LED, 10,000 hrs			
IR DISTANCE	20M			
DAY/NIGHT ON	>5 Lux color; <3 Lux B/W			
VIDEO OUTPUT	1 Vpp, 75 Ohms			

ITEM	HTC-15B	HTC-15I
POWER SUPPLY	DC 12V or AC 24V	
POWER CONSUMPTION	DC 12V: 300mA AC 24V: 4.4W	
DIMENSIONS (φ *H)	φ 131.2x 94.3 mm	
WEIGHT	DC: 380g ; AC 400g	
STORAGE TEMPERATURE	-30 to + 60 °C	
OPERATING TEMPERATURE	-10 to + 45°C	

SPECIFICATIONS ARE SUBJECT TO CHANGE WITHOUT NOTICE

Model	Med-res.	Hi-res.	Resolution (TV Lines)	Sensitivity (F1.2) Lux	IR
HTC-15B/3.6	O		420	0.05	N/A
HTC-15B/3.7-12	O		420	0.05	N/A
HTC-15B/3.7-12/IR	O		420	0.05	O
HTC-15I/3.6		O	540	0.1	N/A
HTC-15I/3.7-12		O	540	0.1	N/A
HTC-15I/3.7-12/IR		O	540	0.1	O