

# MINI DOME CAMERA HTC-12 SERIES

## Main Features

- Compact Size camera
- Auto trace white balance
- Electronic shutter up to 1/100,000 sec
- Night vision (optional)



## Interface

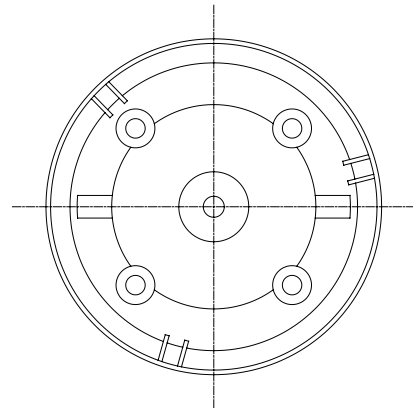
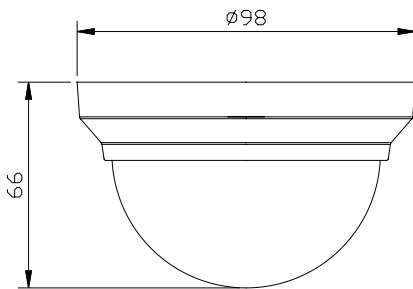

## Specifications

ITEM	HTC-12Q	
PICK UP DEVICE	1/3"CCD Image Sensor	
SYSTEM	NTSC	PAL
PICTURE ELEMENTS H*V	510 * 492	512*582
H. SYNC. FREQUENCY	15.734KHz	15.625KHz
V. SYNC. FREQUENCY	59.94Hz	50Hz
HORIZONTAL RESOLUTION	420 TV Lines	
SCANNING SYSTEM	2:1 Interlace	
SENSITIVITY	0.5 Lux When F1.2	
SYNCHRONIZATION	Internal	
S/N RATIO	More Than 48 dB (AGC Off)	
BACK LIGHT COMPENSATION	Auto	
ELECTRONIC SHUTTER	Auto, Range 1/50(1/60) Up to 1/100,000 sec.	

ITEM	HTC-12Q
GAIN CONTROL	Auto
GAMMA	0.45
LENS	3.6mm (Standard) (3, 6, 8 and 12mm Optional)
DAY/NIGHT ON	>5 Lux color; <3 Lux B/W
VIDEO OUTPUT	1 Vpp, 75 Ohms
POWER SUPPLY	DC 12V
POWER CONSUMPTION	60mA
DIMENSIONS (φ *H)	φ 98 x 66 mm
WEIGHT	110g
STORAGE TEMPERATURE	-30 to + 60 °C
OPERATING TEMPERATURE	-10 to + 45°C

SPECIFICATIONS ARE SUBJECT TO CHANGE WITHOUT NOTICE